

## Partial Height Door Support *CPDS Series*

For use with the C2 cabinet series only.

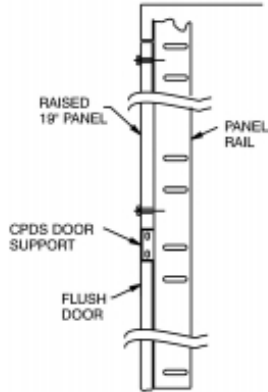

### Features

- Allows partial height flush door installation.
- Requires drilling of rack frame
- Occupies 1.75" (1U) of panel height
- Door support is 0.75" deep
- Constructed of 14 gauge steel.
- Available in two standard colours.

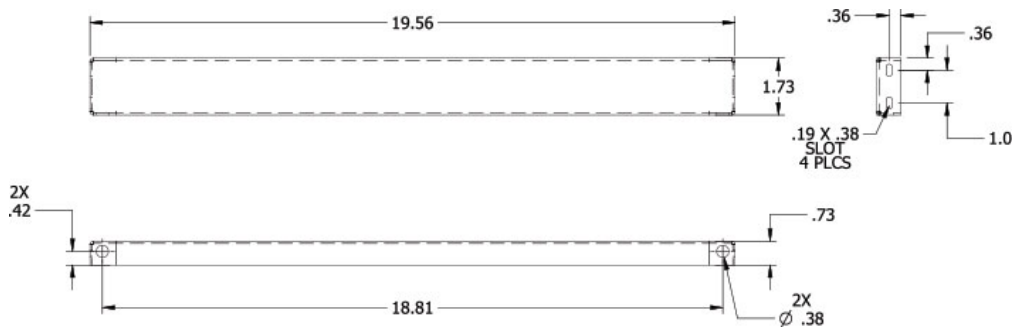

Part No.	Overall Dimensions			Mounting Dimensions		Rack Units
	Height	Width	Depth	Height	Width	
Black CPDS19BK1	1.73	19.56	0.73	1.75	19.00	1U

\*Note: "CG1" (Beige color) is being phased out from stock - replaced with "LG1" a light gray (RAL7035)

*Data subject to change without notice*